

KENAI PENINSULA BOROUGH

Office of the Borough Clerk

144 North Binkley Street
Soldotna, AK 99669
Phone 907-714-2160
Fax 907-714-2388

Johni Blankenship, CMC
Borough Clerk

MEMORANDUM

To: Gary Knopp, Assembly President
Members of the Assembly

Thru: Johni Blankenship, Borough Clerk 

From: Katie Ring, Borough Clerk Secretary 

Date: June 21, 2011

RE: New Liquor License & Restaurant Designation Permit – **Great Alaska Adventure Lodge**

Kenai Peninsula Borough Code 7.10.010 provides for mandatory Assembly review of all applications for new liquor licenses and restaurant designation permits located within the Borough. Accordingly, the attached applications filed by Great Alaska Fish Camp, Inc. dba Great Alaska Adventure Lodge are being submitted to you for review and action.

The Borough Finance Department has reviewed the application and has no objection to the new license based on unpaid taxes. The Planning Department has reviewed the application for proximity to churches and/or schools and has no objection to the new license based on location.

RECOMMENDATION:

That the Assembly authorize a letter of non-objection to the issuance of the new liquor license and approves the restaurant designation permit as requested by **Great Alaska Fish Camp, Inc. dba Great Alaska Adventure Lodge.**

cc: Great Alaska Fish Camp, Inc.
dba Great Alaska Adventure Lodge
33881 Sterling Hwy
Sterling, Alaska 99672

State of Alaska
Alcoholic Beverage Control Board

RECEIVED

MAY 23 2011

Date of Notice: May 23, 2011

Application Type: NEW TRANSFER
 Ownership
 Location
 Name Change

KPB - Clerks Office

Governing Body: **City of Sterling; Kenai Peninsula Borough**
 Community Councils:

License #: **5086**
 License Type: **Lodge**
 D.B.A.*: **Great Alaska Adventure Lodge**
 Licensee/Applicant: **Great Alaska Fish Camp, Inc.**
 Physical Location: **33881 Sterling Hwy
 Sterling, AK 99672**

Mail Address: **33881 Sterling Hwy
 Sterling, AK 99672**
 Telephone #: **(800) 544-2261** Fax: **(907) 262-8797**
 EIN: **92-0102930**

Liquor License Application Review	
TO: <input checked="" type="checkbox"/> Delinquent Accounts <input type="checkbox"/> Planning Department	
DATE: <u>5/23/11</u>	
Review and return to Borough Clerk with comments by: <u>6/22/11</u>	
For Assembly Meeting of <u>7/5/11</u>	
The <u>FINANCE</u> Department has no objection to the issuance of this license.	
Date: <u>5/26/11</u>	By: <u>[Signature]</u>

Corp/LLC Agent:	Address	Phone	Date and State of Limited Partnership/Corporation	Good standing?
Alaska Fish Camp, Inc	33881 Sterling Hwy Sterling, AK 99672	(800) 544-2261	01/22/93	Yes

Please note: the Members/Officers/Directors/Shareholders (principals) listed below are the principal members. There may be additional members that we are not aware of because they are not primary members. We have listed all principal members and those who hold at least 10% shares.

Member/Officer/Director:	DOB	Address	Phone	Title/Shares (%)
Laurence John		33881 Sterling Hwy Sterling, AK 99672	907-262-4515	President / 51%
Kent L. John		19203 SW Megly Ct. Lk Oswggo, OR 97035	360-434-7347	Vice Pres / 15%
Kathleen Haley		PO Box 1194 Sterling, AK 99672	907-252-2496	Vice Pres / 33%
Debra Edwards John		33881 Sterling Hwy Sterling, AK 99672	907-262-4515	Sec/Treas / 0
Julie Gorset John		19203 SW Megly Ct. Lk Oswggo, OR 97035	360-434-7347	Affiliate / 0
John Haley		PO Box 1194 Sterling, AK 99672	907-252-2496	Affiliate / 0

If transfer application, current license information:

License #:
Current D.B.A.:
Current Licensee:
Current Location:

A local governing body as defined under AS 04.21.080(11) may protest the approval of an application(s) pursuant to AS 04.11.480 by furnishing the board **and** the applicant with a clear and concise written statement of reasons in support of a protest within 60 days of receipt of this notice. If a protest is filed, the board will not approve the application unless it finds that the protest is "arbitrary, capricious and unreasonable". Instead, in accordance with AS 04.11.510(b), the board will notify the applicant that the application is denied for reasons stated in the protest. The applicant is entitled to an informal conference with either the director or the board and, if not satisfied by the informal conference, is entitled to a formal hearing in accordance with AS 44.62.330-44.62-630. **IF THE APPLICANT REQUESTS A HEARING, THE LOCAL GOVERNING BODY MUST ASSIST IN OR UNDERTAKE THE DEFENSE OF ITS PROTEST.**

Under AS 04.11.420(a), the board may not issue a license or permit for premises in a municipality where a zoning regulation or ordinance prohibits the sale or consumption of alcoholic beverages, unless a variance of the regulation or ordinance has been approved. Under AS 04.11.420(b) municipalities must inform the board of zoning regulations or ordinances which prohibit the sale or consumption of alcoholic beverages. If a municipal zoning regulation or ordinance prohibits the sale or consumption of alcoholic beverages at the proposed premises and no variance of the regulation or ordinance has been approved, please notify us and provide a certified copy of the regulation or ordinance if you have not previously done so.

Protest under AS 04.11.480 and the prohibition of sale or consumption of alcoholic beverages as required by zoning regulation or ordinance under AS 04.11.420(a) are two separate and distinct subjects. Please bear that in mind in responding to this notice.

AS 04.21.010(d), if applicable, requires the municipality to provide written notice to the appropriate community council(s).

If you wish to protest the application referenced above, please do so in the prescribed manner and within the prescribed time. Please show proof of service upon the applicant. For additional information please refer to 13 AAC 104.145, Local Governing Body Protest.

Note: Applications applied for under AS 04.11.400(g), 13 AAC 104.335(a)(3), AS 04.11.090(e), and 13 AAC 104.660(e) must be approved by the governing body.

Sincerely,

/s/ Leighanne D. Atwood
Leighanne D. Atwood
Business Registration Examiner

Alcoholic Beverage Control Board
5848 E. Tudor Rd Anchorage, AK 99507 - Voice (907) 269-0350 - Fax (907) 272-9412

Memorandum

To: Johni Blankenship, Borough Clerk
Thru: Craig Chapman, Finance Director *BA go CCC*
From: *w* Lauri Lingafelt, Delinquent Accounts Specialist
Date: May 26, 2011
Subject: New Liquor License

Lodge—Kenai Peninsula Borough

License #5086

Great Alaska Fish Camp Inc.

Db a Great Alaska Adventure Lodge

President: Laurence John

Location: 33881 Sterling Hwy

Mail: 33881 Sterling Hwy
Sterling, AK 99672

Please be advised that the Kenai Peninsula Borough Finance Department has no objection to the new liquor license application for the above noted liquor license based on unpaid taxes.

All tax accounts registered to the business and/or applicants are current at this time.

Please forward us a copy of the Assembly approval/objection letter for our records. Thank you for your consideration in this matter.



KENAI PENINSULA BOROUGH

PLANNING DEPARTMENT

144 North Binkley Street • Soldotna, Alaska 99669-7520

PHONE: (907) 714-2200 • **FAX:** (907) 714-2378

Toll-free within the Borough: 1-800-478-4441, Ext. 2200

www.borough.kenai.ak.us

**DAVE CAREY
BOROUGH MAYOR**

M E M O R A N D U M

TO: Johni Blankenship, Borough Clerk

FROM:  Max Best, Planning Director

RE: Great Alaska Adventure Lodge New Liquor License Application

DATE: June 1, 2011

As requested, the Planning Department reviewed the Great Alaska Adventure Lodge new liquor license application to determine if churches or schools are within 500 feet (KPB 7.10.020). A 500-foot radius search was done for KPB Parcel 065-012-01, 33881 Sterling Highway, Sterling.

Churches and schools are included in the institutional land use classification. The institutional parcel on the land use map is a park facility owned by the Alaska Department of Fish and Game.

Kenai Peninsula Borough records show no schools or churches within the 500-foot buffer.

Maps and land status information are attached.

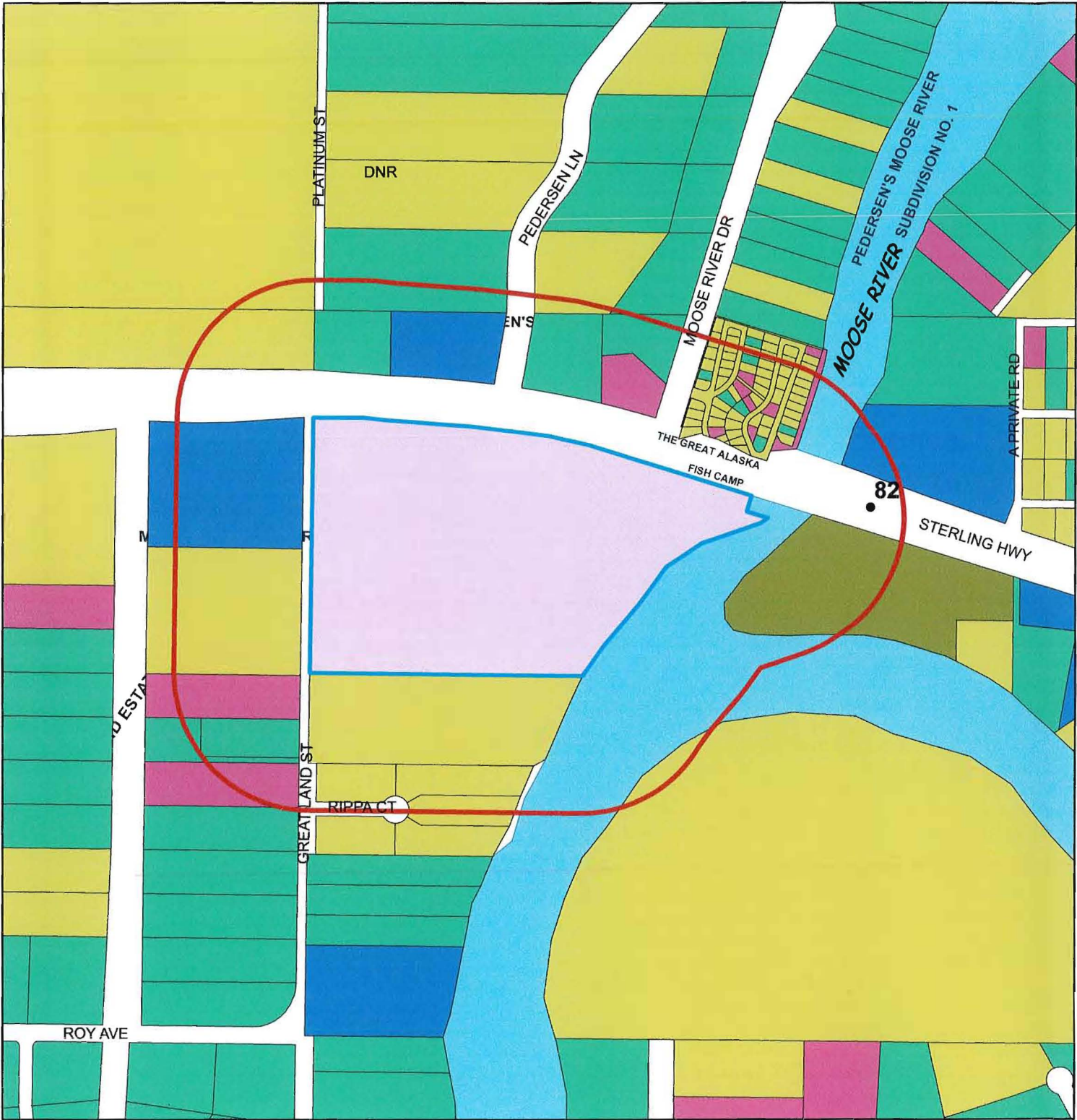

Great Alaska Adventure Lodge
 New Liquor License Application
 Land Use within 500 Feet

LAND USE

- Accessory Building
- Commercial
- Industrial
- Institutional
- Residential
- Timber/Farm
- Vacant

The information depicted hereon is for a graphical representation only of best available sources. The Kenai Peninsula Borough assumes no responsibility for any errors on this map.

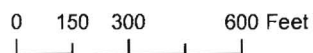



Date: 6/1/2011

Great Alaska Adventure Lodge

The information depicted hereon is for a graphical representation only of best available sources. The Kenai Peninsula Borough Planning Department assumes no liability for any errors on this map.



PARCEL ID	USAGE	ACREAGE	OWNER	ADDRESS	CITY/STATE/Z
06333054	100 Residential Vacant	80.00	COOK INLET REGION INC	PO BOX 93330	ANCHORAGE, AK 99509
06353016	110 Residential Dwelling - single	2.09	NICHOLSON LARRY D & SONYA A	PO BOX 1262	STERLING, AK 99672
06353017	110 Residential Dwelling - single	2.09	ABBOTT R BARRY	PO BOX 994	STERLING, AK 99672
06353019	190 Residential Accessory Bldg	2.07	POULSON DANIEL J	2112 W 32ND AVE	ANCHORAGE, AK 99517
06353023	110 Residential Dwelling - single	0.92	JUSTICE DAVID	PO BOX 1001	STERLING, AK 99672
06353024	110 Residential Dwelling - single	1.18	COLLINS NOEL C	PO BOX 2273	SOLDOTNA, AK 99669
06353025	100 Residential Vacant	6.43	THIBODEAU GUY J & LINDA	1567 EVERGREEN AVE	JUNEAU, AK 99801
06353028	350 General Commercial	6.04	PENNINGTON BARBARA E & GILBERTSON SUSAN V	PO BOX 1321	STERLING, AK 99672
06353029	100 Residential Vacant	6.04	POULSON DONALD W	PO BOX 1385	STERLING, AK 99672
06501201	350 General Commercial	25.21	GREAT ALASKA FISH CAMP INC	33881 STERLING HWY	STERLING, AK 99672
06501202	100 Residential Vacant	7.00	GREAT ALASKA FISH CAMP INC	33881 STERLING HWY	STERLING, AK 99672
06501208	100 Residential Vacant	42.47	ALASKA STATE DNR	550 W 7TH AVE STE 650	ANCHORAGE, AK 99501
06501301	100 Residential Vacant	0.92	THORNTON JERAMIE W	1270 E PORTOBELLO CT	EAGLE, ID 83616
06501302	100 Residential Vacant	1.24	DOGGETT CLARISSA	2440 E TUDOR RD	ANCHORAGE, AK 99507
06501303	100 Residential Vacant	0.97	PICKENS MARVIN	20341 PHILADELPHIA WAY	EAGLE RIVER, AK 99577
06503002	350 General Commercial	4.49	MOOSE RIVER PROPERTIES LLC	PO BOX 110071	ANCHORAGE, AK 99511
06522024	850 General Institutional	5.42	ALASKA STATE FISH & GAME	333 RASPBERRY RD	ANCHORAGE, AK 99518
06522025	110 Residential Dwelling - single	4.64	TOLLEFSEN RYAN W	PO BOX 243811	ANCHORAGE, AK 99524
06522026	350 General Commercial	2.28	KUNZ MICHAEL T & GLORIA A	PO BOX 627	STERLING, AK 99672
06522028	130 Residential Mobile Home	1.46	BRAZINGTON MARVIN & MILDRED	PO BOX 71	STERLING, AK 99672
06522036	100 Residential Vacant	2.62	PEDERSEN ELISA	PO BOX 128	STERLING, AK 99672
06522044	110 Residential Dwelling - single	1.55	SHOWALTER TWYLA	PO BOX 84	STERLING, AK 99672
06522050	110 Residential Dwelling - single	1.88	TROYER LLOYD	38460 PEDERSEN LN	STERLING, AK 99672
06522051	190 Residential Accessory Bldg	0.93	BANGERTER KENT C	4255 S 300 W STE 4	MURRAY, UT 84107
06557002	110 Residential Dwelling - single	1.17	MARTIN GLEN F	PO BOX 1389	SOLDOTNA, AK 99669
06557003	100 Residential Vacant	0.06	ALASKA STATE D O T	PO BOX 196900	ANCHORAGE, AK 99519
06557004	105 Residential Improved Land	0.05	FREIE JOHN H TRUSTEE	4853 NOTTINGHAM WAY	ANCHORAGE, AK 99503
06557005	100 Residential Vacant	0.05	KENAI RIVER R V CAMP INC	33881 STERLING HWY	STERLING, AK 99672
06557006	100 Residential Vacant	0.04	KENAI RIVER R V CAMP INC	33881 STERLING HWY	STERLING, AK 99672
06557007	100 Residential Vacant	0.04	DE LONGCHAMP ROGER	PO BOX 906	WILLOW, AK 99688
06557010	190 Residential Accessory Bldg	0.04	DELONGCHAMP BARBARA A	8520 REBEL RIDGE DR	ANCHORAGE, AK 99504
06557015	100 Residential Vacant	0.04	BROOKS LINDA J	11111 NW 113TH PL	CHIEFLAND, FL 32626
06557016	100 Residential Vacant	0.04	KENAI RIVER R V CAMP INC	33881 STERLING HWY	STERLING, AK 99672
06557017	100 Residential Vacant	0.05	WHITED BRUCE J & JOAN	PO BOX 901	MOUNTAIN HOME, ID 83647
06557018	100 Residential Vacant	0.04	MULLICAN IDA B	1709 HAMILTON DR	ANCHORAGE, AK 99515
06557019	100 Residential Vacant	0.04	MULLICAN IDA B	1709 HAMILTON DR	ANCHORAGE, AK 99515
06557020	100 Residential Vacant	0.04	MULLICAN IDA B	1709 HAMILTON DR	ANCHORAGE, AK 99515
06557021	100 Residential Vacant	0.04	KENAI PENINSULA BOROUGH	144 N BINKLEY ST	SOLDOTNA, AK 99669
06557022	100 Residential Vacant	0.03	KENAI PENINSULA BOROUGH	144 N BINKLEY ST	SOLDOTNA, AK 99669
06557023	100 Residential Vacant	0.04	KENAI RIVER R V CAMP INC	33881 STERLING HWY	STERLING, AK 99672
06557024	100 Residential Vacant	0.01	KENAI RIVER R V CAMP INC	33881 STERLING HWY	STERLING, AK 99672
06557025	100 Residential Vacant	0.02	KENAI RIVER R V CAMP INC	33881 STERLING HWY	STERLING, AK 99672
06557026	190 Residential Accessory Bldg	0.05	KENAI RIVER R V CAMP INC	33881 STERLING HWY	STERLING, AK 99672
06557027	100 Residential Vacant	0.05	KENAI RIVER R V CAMP INC	33881 STERLING HWY	STERLING, AK 99672
06557028	100 Residential Vacant	0.05	KENAI RIVER R V CAMP INC	33881 STERLING HWY	STERLING, AK 99672
06557029	100 Residential Vacant	0.05	KENAI RIVER R V CAMP INC	33881 STERLING HWY	STERLING, AK 99672
06557030	100 Residential Vacant	0.05	KENAI RIVER R V CAMP INC	33881 STERLING HWY	STERLING, AK 99672
06557031	100 Residential Vacant	0.05	KENAI RIVER R V CAMP INC	33881 STERLING HWY	STERLING, AK 99672
06557036	100 Residential Vacant	0.04	KENAI RIVER R V CAMP INC	33881 STERLING HWY	STERLING, AK 99672
06557037	100 Residential Vacant	0.04	KENAI RIVER R V CAMP INC	33881 STERLING HWY	STERLING, AK 99672
06557038	100 Residential Vacant	0.04	PATTERSON GEORGE E & GRACE TRUSTEES	21835 N MAYA CT	SUN CITY WEST, AZ 85375
06557039	100 Residential Vacant	0.04	MOORE RONALD	PO BOX 671870	CHUGIAK, AK 99567

PARCEL_ID	USAGE	ACREAGE	OWNER	ADDRESS	CITY/STATE/ZIP
06557040	100 Residential Vacant	0.04	MOORE RONALD	PO BOX 671870	CHUGIAK, AK 99567
06557041	100 Residential Vacant	0.04	MOORE RONALD	PO BOX 671870	CHUGIAK, AK 99567
06557042	190 Residential Accessory Bldg	0.04	KENAI RIVER R V CAMP INC	33881 STERLING HWY	STERLING, AK 99672
06557043	100 Residential Vacant	0.05	KENAI RIVER R V CAMP INC	33881 STERLING HWY	STERLING, AK 99672
06557044	100 Residential Vacant	0.05	KENAI RIVER R V CAMP INC	33881 STERLING HWY	STERLING, AK 99672
06557045	100 Residential Vacant	0.05	KENAI RIVER R V CAMP INC	33881 STERLING HWY	STERLING, AK 99672
06557046	105 Residential Improved Land	0.05	KENAI RIVER R V CAMP INC	33881 STERLING HWY	STERLING, AK 99672
06557047	100 Residential Vacant	0.04	KENAI RIVER R V CAMP INC	33881 STERLING HWY	STERLING, AK 99672
06557048	100 Residential Vacant	0.03	KENAI RIVER R V CAMP INC	33881 STERLING HWY	STERLING, AK 99672
06557050	190 Residential Accessory Bldg	0.05	KENAI RIVER R V CAMP INC	33881 STERLING HWY	STERLING, AK 99672
06557051	100 Residential Vacant	0.04	KENAI RIVER R V CAMP INC	33881 STERLING HWY	STERLING, AK 99672
06557052	100 Residential Vacant	0.04	JACKSON ANDREW	6490 LONGHORN LN	PAHRUMP, NV 89061
06557053	100 Residential Vacant	0.04	KELLER YVONNE RAE	3624 BURL CT	ANCHORAGE, AK 99504
06557054	100 Residential Vacant	0.04	JACKSON ANDREW	6490 LONGHORN LN	PAHRUMP, NV 89061
06557055	100 Residential Vacant	0.05	JACKSON ANDREW	6490 LONGHORN LN	PAHRUMP, NV 89061
06557056	100 Residential Vacant	0.05	DUNN STEVE	PO BOX 232156	ANCHORAGE, AK 99523
06557057	100 Residential Vacant	0.04	DUNN TONY	PO BOX 232156	ANCHORAGE, AK 99523
06557058	100 Residential Vacant	0.04	DUNN TONY	17351 BEAUJOLAIS CIR	EAGLE RIVER, AK 99577
06557059	120 Residential Cabin - single	0.05	VILLACAMA JOHN M	PO BOX 1355	STERLING, AK 99672
06557063	190 Residential Accessory Bldg	0.04	DUNN REVOCABLE TRUST	7564 WHITE HAWK DR	ANCHORAGE, AK 99507
06557064	100 Residential Vacant	0.04	DUNN REVOCABLE TRUST	7564 WHITE HAWK DR	ANCHORAGE, AK 99507
06557065	100 Residential Vacant	0.04	DUNN REVOCABLE TRUST	7564 WHITE HAWK DR	ANCHORAGE, AK 99507
06557066	100 Residential Vacant	0.04	DUNN REVOCABLE TRUST	7564 WHITE HAWK DR	ANCHORAGE, AK 99507
06557067	100 Residential Vacant	0.04	JOHNSON TERRY W & HARRIGAN BRIAN C	5114 87TH STREET CT E	TACOMA, WA 98446
06557068	100 Residential Vacant	0.04	POLKE DAVID A & TINNIE L	1021 S GREENFIELD RD UNIT 1101	MESA, AZ 85206
06557069	100 Residential Vacant	0.04	POLKE DAVID A & TINNIE L	1021 S GREENFIELD RD UNIT 1101	MESA, AZ 85206
06557070	100 Residential Vacant	0.04	KENAI RIVER R V CAMP INC	33881 STERLING HWY	STERLING, AK 99672
06557071	190 Residential Accessory Bldg	0.04	KENAI RIVER R V CAMP INC	33881 STERLING HWY	STERLING, AK 99672
06557072	100 Residential Vacant	0.04	KENAI RIVER R V CAMP INC	33881 STERLING HWY	STERLING, AK 99672
06557073	100 Residential Vacant	0.08	KENAI RIVER R V CAMP INC	33881 STERLING HWY	STERLING, AK 99672
06557074	100 Residential Vacant	0.42	KENAI RIVER R V CAMP INC	33881 STERLING HWY	STERLING, AK 99672
06557075	100 Residential Vacant	0.01	KENAI RIVER R V CAMP INC	33881 STERLING HWY	STERLING, AK 99672
06557076	100 Residential Vacant	0.04	KENAI RIVER R V CAMP INC	33881 STERLING HWY	STERLING, AK 99672
06557077	190 Residential Accessory Bldg	0.24	KENAI RIVER R V CAMP INC	33881 STERLING HWY	STERLING, AK 99672
06557078	100 Residential Vacant	0.03	KENAI RIVER R V CAMP INC	33881 STERLING HWY	STERLING, AK 99672



Government ownership

PIN: **06503003**

TAG: **58 - CENTRAL EMERGENCY SERVICES**

Current owner: **ALASKA STATE FISH & GAME**

AIN:

TIF:

Ownership type: **Government Owner**

Status: **Active**

Case:

Situs address

Geocode:

Plan:

Description: **T 5N R 8W SEC 7 Seward Meridia**

Rev acct: **0000097103**

Roll type: **Real Property**

Class: **850 General Institutional**

Values

Value Date	1/1/2010
Land	467,600
Improvements	74,500
KPB Assessed	542,100
KPB Exempt	542,100

Value Modifiers

GOV Government

Dwelling Info

#Floors #Rooms Bedrooms Bath TLA BSMT Attic Card Garage Attached

Improvements

Type	Year_Built	Cond	Grade	Card
MACHINE	1985	AV	Low	C01
RESTROOM	1985	AV	P	C01
RESTROOM	1985	AV	P	C02
DRIVE	3000	AV	Avg	C01

Land

Type	Unit
Riverfront A	5.4200 Acres

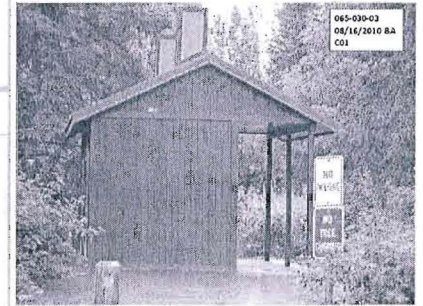

STATE OF ALASKA
ALCOHOLIC BEVERAGE CONTROL BOARD
APPLICATION FOR RESTAURANT DESIGNATION PERMIT - AS 04.16.049 & 13 AAC 104.715-794

FEE: \$50.00

The granting of this permit allows access of persons under 21 years of age to designated licensed premises for purposes of dining, and persons under the age of 19 for employment. If for employment, please state in detail, how the person will be employed, duties, etc. (13 AAC 104.745).

This application is for designation of premises where: (please mark appropriate items).

- 1 Under AS 04.16.010(c) Bona fide restaurant/eating place.
- 2 Persons age 16 to 20 may dine unaccompanied.
- 3 Persons under 16 may dine accompanied by a person 21 years or older.
- 4 Persons between 16 and 19 years may be employed. (See note below).

LICENSEE: GREAT ALASKA FISH CAMP

D/B/A: GREAT ALASKA ADVENTURE LODGE

ADDRESS: 33881 STERLING HWY, STERLING, AK, 99672

1. Hours of Operation: 4:00AM to 10:00PM Telephone # 800 544 2261
2. Have police ever been called to your premises by you or anyone else for any reason: [] Yes [X] No
If yes, date(s) and explanation(s).

3. Duties of employment: _____

4. Are video games available to the public on your premises? NO

5. Do you provide entertainment: [] Yes [X] No If yes, describe: _____

6. How is food served? Table Service Buffet Service Counter Service Other*

7. Is the owner, manager, or assistant manager always present during business hours? [X] Yes [] No

*** A MENU AND A DETAILED LICENSED PREMISES DIAGRAM MUST ACCOMPANY THIS APPLICATION ***

This permit remains in effect until the liquor license is transferred OR at the discretion of the Alcoholic Beverage Control Board. (13 AAC 104.795)

I certify that I have read AS 04.16.049, AS 04.16.060, 13 AAC 104.715-795 and have instructed my employees about provisions contained therein.

[Signature]
Applicant(s) signature

Subscribed and sworn to before me this 17th day of May 2011

[Signature]
Notary Public in and for Alaska

My Commission expires 6/26/14

Application approved (13 AAC 104.725(e))
Governing Body Official

Date: _____

Director, ABC Board

Date: _____

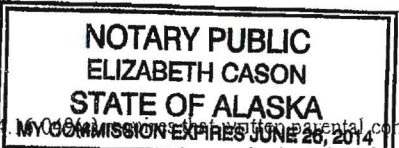

NOTE: AS 04.16.049 requires the written parental consent and an exemption by the Department of Labor must be provided to the licensee by the employer who is under 19 years of age. Persons 19 and 20 years of age are not required to have the consent or exemption.

* Describe how food is served on back of form.

GREAT ALASKA ADVENTURE LODGE

MENU

BREAKFAST (4:45 - 8:00 AM)

EGGS & MEAT - FRENCH TOAST - BISCUITS & GRAVY
PANCAKES - EGGS BENEDICT
COFFEE - FRUIT - JUICE - TOAST - CEREAL

LUNCH

SANDWICH BAR WHERE GUESTS PREPARE
THEIR OWN LUNCH

ASSORTED BREADS & MEATS, CONDIMENTOS,
COOKIES, CHIPS AND SOFT DRINKS & WATER

DINNER

ENTRES INCLUDE SALMON, HALIBUT,
PRIME RIB - CHICKEN - BBQ.
SALAD, SOUP, DESSERTS

MENU IS THE SAME FARE EACH WEEK
OF THE SUMMER (6/1 - 9/30)

* NOTE: WE HAVE A PRINTED VERSION OF THE ABOVE
MENU, BUT MY PRINTER FAILED.

STATE OF ALASKA
ALCOHOL BEVERAGE CONTROL BOARD
Licensed Premises Diagram

INSTRUCTIONS: Draw a detailed floor plan of your present or proposed licensed premises on the graph below; show all entrances and exits, and all fixtures such as tables, booths, games, counters, bars, coolers, stages, etc.

DBA: GREAT ALASKA ADVENTURE LODGE

PREMISES LOCATION: 33881 STERLING HWY, STERLING, AK 99672

Indicate scale by x after appropriate statement or show length and width of premises.

SCALE A: X 1 SQ. = 4 FT. SCALE B: _____ 1 SQ. = 1 FT.

Length and width of premises in feet: ~~66~~ X 84
66

Outline the area to be designated for sale service storage and consumption of alcoholic beverages in red
DO NOT USE BLUE INK OR PENCIL ON THIS DIAGRAM.

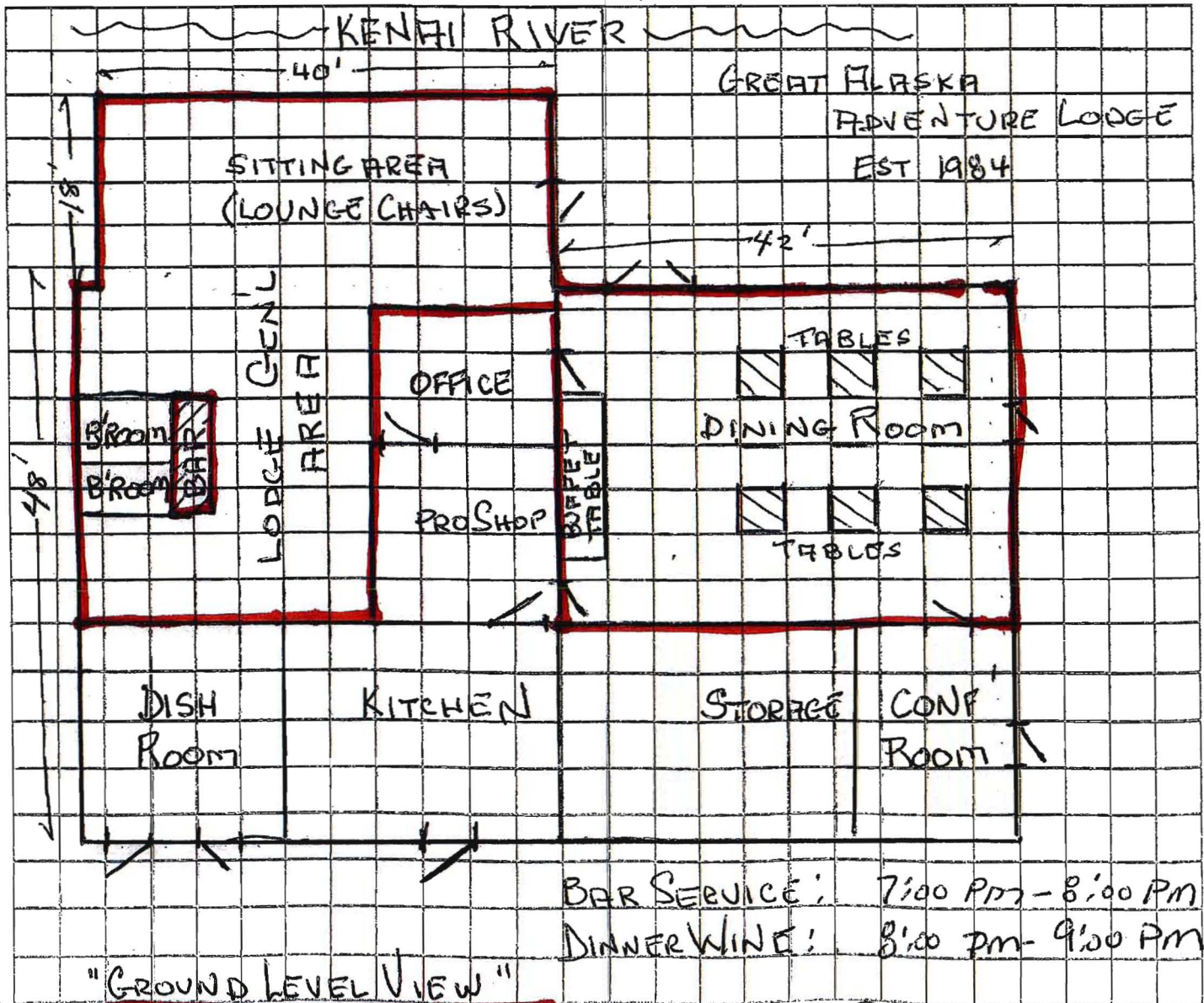

STATE OF ALASKA
ALCOHOL BEVERAGE CONTROL BOARD
Licensed Premises Diagram

INSTRUCTIONS: Draw a detailed floor plan of your present or proposed licensed premises on the graph below; show all entrances and exits, and all fixtures such as tables, booths, games, counters, bars, coolers, stages, etc.

DBA: GREAT ALASKA ADVENTURE LODGE

PREMISES LOCATION: 33881 STERLING HWY, STERLING AK 99672

Indicate scale by x after appropriate statement or show length and width of premises.

SCALE A: X 1 SQ. = 4 FT. SCALE B: _____ 1 SQ. = 1 FT.

Length and width of premises in feet: 48 x 48

Outline the area to be designated for sale service storage and consumption of alcohol beverages in red
DO NOT USE BLUE INK OR PENCIL ON THIS DIAGRAM.

